

The Lighthouse

SCOTLAND'S CENTRE FOR DESIGN AND ARCHITECTURE

The Lighthouse, 11 Mitchell Lane, Glasgow, G1 3NU

Tel: 0141 276 5365

Email: information.thelighthouse@glasgow.gov.uk

Website: www.thelighthouse.co.uk



Contents

VISIT – WHAT TO SEE AT A GLANCE.....	- 2 -
ABOUT US.....	- 3 -
GETTING HERE.....	- 5 -
ON ARRIVAL.....	- 6 -
WHEELCHAIR USERS/BUGGIES/LUGGAGE.....	- 9 -
PRE ARRIVAL.....	- 11 -
ARRIVAL.....	- 12 -
EXHIBITIONS.....	- 13 -
MACKINTOSH CENTRE.....	- 15 -
TOURS.....	- 17 -
DOOCOT CAFE.....	- 18 -
FLOOR PLAN.....	- 19 -
ESSENTIAL INFORMATION.....	- 19 -
VIRTUAL TOUR.....	- 21 -

VISIT – WHAT TO SEE AT A GLANCE

Floor Plan

Ground floor

Reception

Building Tours

The Lighthouse Gift Shop

Exhibitions (Visit www.thelighthouse.co.uk for details)

First Floor - Gallery 1

Second Floor - Gallery 2

Architecture & Design Scotland (A+DS)

Materials Library

Third Floor – Gallery 3

Charles Rennie Mackintosh Interpretation Centre

Mackintosh Tower (Stairs only)

External Balcony space

Fourth Floor – Gallery 4

Fifth Floor – Gallery 5

Doocot Café

Sixth Floor – Viewing Platform

ABOUT US

The Lighthouse, Scotland's Centre for Design and Architecture, is a visitor centre, exhibition space and events venue situated in the heart of Glasgow, just off the Style Mile. The Lighthouse acts as a beacon for the creative industries in Scotland and promotes the impact of design and architecture through a vibrant programme of exhibitions and events.

Formerly housing The Glasgow Herald, The Lighthouse was the first large building completed by Charles Rennie Mackintosh, and is the perfect place to begin a Mackintosh tour of Glasgow. Please watch our video so we can take you on a tour of the building and show you what you can do when you visit: <http://www.thelighthouse.co.uk/venue/virtual-tours>

Admission: Free

Opening Hours

Monday to Saturday: 10.30am – 5.00pm

Sunday: 12.00pm – 5.00pm

Closed 25 December to 2 January Inclusive

The Lighthouse is fully accessible for wheelchair users or those with specific access needs. We have a passenger lift accessing all 6 floors. There are 5 disabled parking spaces at the side of the building on Mitchell Street.

The building houses 4 office spaces, which are let to the creative industry companies. The building also comprises of 6 unique conference and meeting spaces, which we hire out for private events.

If you require any further information about specific access or need advice on planning your visit please contact us by telephone: +44 (0)141 276 5365 (lines are open Monday to Friday, 9am until 5pm) or email reception@thelighthouse.co.uk If we have not met your access requirements, please contact us to discuss how we can help.

GETTING HERE

The Lighthouse is situated in the heart of Glasgow City Centre. We are located just off Buchanan Street, which is extremely convenient for all modes of transport

- Queen Street St (Rail)
- Glasgow Central St (Rail)
- St Enoch's Underground
- Buchanan Underground
- Buchanan Bus Station
- Disabled parking at side of building approx. 40 meters on Mitchell St
- Taxi, nearest taxi rank Glasgow Central St
- Parking at NCP car park Mitchell Street
- Parking at Q Park Jamaica Street (5 min walk) our reception staff can issue a discount voucher which reduces your fee to £6 for up to 24 hours stay
- Cycling – Please ask our reception staff to guide you to our bike racks



ON ARRIVAL

Arriving at Mitchell Lane from Mitchell Street



On entering the lane you should take position to the right, there are 6 square bollards about one meter high when you come to the 6th turn right and you will be facing our entrance. There are two entrance points. On the right hand side, you can enter via the revolving door. Push the revolving door otherwise it will revolve very slowly. On the left hand side, you can enter using the panel doors using the keypad located on the wall on the left hand side as you face the building.

Arriving at Mitchell Lane from Buchanan Street



On entrance to the lane you should take position to the left, there are 3 square bollards about one meter high when you come to the 3rd turn left and you will be facing our entrance. There are two entrance points. On the right hand side, you can enter via the revolving door. Push the revolving door otherwise it will revolve very slowly. On the left hand side, you can enter using the panel doors using the keypad located on the wall on the left hand side as you face the building.

Our friendly reception staff will welcome you upon arrival and let you know what is on. Please check our website or phone reception before arrival as we sometimes close areas for private functions.



Our gift shop is located on the ground floor behind our reception area.

The Lighthouse spans over 6 floors, which are all accessible by the lift. You can take escalators or stairs to all other floors.

“This is one of the coolest art gallery's I've ever visited. You can take a lift up to a viewing room that have stunning views over the city centre or better still climb the spiral staircase to the top of the Macintosh tower and take in even more amazing views of the city and beyond. I really recommend a visit! I'm terrified of heights but the views are worth it believe me!”

Andrew S on Yelp, 8/3/2015

WHEELCHAIR USERS/BUGGIES/LUGGAGE

The building is fully accessible for wheelchair users and people with buggies.

Use the lift which is located behind our reception desk on the ground floor to access each level. If our lift is out of order please see a member of staff who will let you know what the alternatives are.

Dimensions of our lift are: 1m wide.



BUGGIES

We have an area for buggy parking on the ground level. Please ask a member of our staff for further information.

LUGGAGE

We have a small cupboard on the ground level which we are happy to store visitors' luggage in. This is not set up for a cloakroom but we are happy to accommodate where we can. This cupboard is locked but items are left at the owners' risk. The management do not accept responsibility for property which is damaged or stolen. We advise our visitors to take

valuables with them whilst visiting the building and exhibitions. Due to limited space this service is on a first come first served basis.

PRE ARRIVAL

- Please check our website www.thelighthouse.co.uk for updates on exhibition dates and for information on any closures
- You can find a full list of what's on in the building by checking our website, social media channels or by phoning reception +44 (0)141 276 5365
- If you would like a tour of the building please note that building tours from Sunday to Wednesday need to be booked 24 hours in advance. Please call us on +44 (0)141 276 5365 to book.

If you would like a tour from Thursday to Saturday we run additional tours which don't need to be booked in advance. These run at the following times: 11am, 12pm, 1pm and 2pm.

- Why not book at table in our café for lunch? Contact our Doocot café staff on +44 (0)141 276 5366. Let the café team know of any food allergies or intolerance prior to arrival.

ARRIVAL

Assistance dogs are welcome.

Public Toilets

There are toilets situated on level 2, level 3 and level 5.

Disabled toilets are located on level 2, level 3 and level 5 with wide doors for wheelchair access, grab rails, emergency cord, easy-turn taps, lowered sink, hand drying facilities and bin.

Baby changing facilities are located on level 4.

Ground Level

Reception

Our Customer Services Assistants are located on the ground floor reception and the upper galleries. We pride ourselves on giving our visitors and clients a warm welcome.

The Lighthouse Shop

The shop on the ground floor is fully accessible.

There is merchandise stored on high shelves, The Lighthouse Shop staff are available from our opening hours to assist you in any way they can.

You can contact them prior to your visit: +44 (0)141 276 5365.

EXHIBITIONS

Portable hearing loops are not currently available for our guided tours or exhibitions. The Conference Suite on level 3 has a hearing loop available. The majority of talks take place in this location.

Our temporary exhibitions information is on printed material such as panel boards and hand-outs. If you require large print please contact us prior to your visit.

Review Gallery

The exhibitions here change regularly and we programme it with installations by young and imaginative designers and architects from Scotland, UK and Europe.

Gallery 1 – Level 1

Temporary Exhibition

Please see website for current exhibitions

<http://www.thelighthouse.co.uk/visit/exhibitions>

Gallery 2 – Level 2

Temporary Exhibition

Please see website for current exhibitions

<http://www.thelighthouse.co.uk/visit/exhibitions>

Material Considerations: A Library of Sustainable Building Materials:

The purpose of the Library is to showcase sustainable, traditional and emerging low carbon building products in general and to promote and

encourage innovation in construction in Scotland using indigenous resources.

MACKINTOSH CENTRE

Our permanent Mackintosh Interpretation Centre or 'Mack' Centre, designed by Gareth Hoskins Architects, Glasgow's most famous architect and designer, explores the life and work.

This is the ideal place from which to start the Mackintosh trail. Here you can also see how the former Glasgow Herald building (Mackintosh's first public commission) was transformed into The Lighthouse, Scotland's Centre for Design and Architecture.

The Entrance

The white, curved glass screen, suspended between floor and ceiling, at the entrance creates two exhibition areas dividing the present and interpretative sections of the display. This glass arc also directs the visitor towards the exposed stonework of the tower and provides a vivid contrast of textures.

The Helical Staircase / Mack Tower

A state-of-the-art helical staircase suspended from the original water tower allows visitors to climb to the top of the tower to the external viewing gallery, which lies beneath the ogee arch of the roof. Drawings, by architect Joyce Michie, of the building's design and construction can be seen as the viewer ascends the staircase. The Mack Tower is not wheelchair accessible.

The Interpretive Section

The interpretative section is organised into three areas. A series of video narratives deal with specific aspects of Mackintosh's work, while on the adjacent wall, there are detailed studies of four key buildings. These displays are bracketed by a chronological timeline that outline the lives and careers of both Mackintosh and his wife, Margaret Macdonald. The buildings examined within the centre are the Glasgow School of Art, the Hill House, the Willow Tearoom and Derngate. As well as being examples of some of his best work, they provide a broad spectrum of Mackintosh's achievements. Touchscreens are wheelchair accessible.

The spaces created between each of the key building rooms contain studies of particular aspects of Mackintosh's work. These focus on architecture, design, interiors and painting and drawings.

The Later Years

The curve of the timeline screen guides visitors to the last of the spaces in the centre. The final section looks at the latter years of the Mackintosh's life in Porte Vendres and London; it also focuses on the reputation, influence and legacy of their work. This part of the exhibition details changes in how Mackintosh's work has been perceived since his death by using comment from contemporary designers and examples of how he is viewed by today's media.

Please contact us prior to visiting if you have a visual impairment and we can arrange for a member of our team to provide a narrative tour.

TOURS

Building Tour

Price: £7 Concession price : £5

Times: Sunday - Wednesday: 11am.

Thursday, Friday & Saturday 11am, 12pm, 1pm, 2pm

Duration: 40 minutes

Glasgow city centre has a wealth of historic buildings including numerous industrial and commercial buildings of significant architectural merit, none more so than The Lighthouse, the former Glasgow Herald Building. Our building tours provide a fascinating insight into the design features and architectural heritage of Charles Rennie Mackintosh's first public commission.

Relax and enjoy a complimentary tea or coffee in the Doocot café at the end of the tour.

Building tours Sunday - Wednesday need to be booked 24 hours in advance.

Building tours Thursday - Saturday at 11am, 12pm, 1pm and 2pm do not need to be booked in advance.

If you would like to book a tour please contact our team:

- Email: information.thelighthouse@glasgow.gov.uk

- Telephone: +44 (0)141 276 5365.

DOOCOT CAFE

Situated on level 5 of The Lighthouse, the Doocot Café Bar offers a selection of snacks and light bites including sandwiches, baked potatoes and Panini's. Daily specials are also available along with home baking and pastries and an extensive range of coffee and tea.

Open Monday to Saturday 10.30am to 4.30pm and from 12.00pm to 4.30pm on Sundays, the Doocot is the perfect pit stop to grab a coffee or a bite to eat while you are in the city centre.

A children's menu and takeaway menu are also available.

Assistance dogs welcome.

Baby chairs available

Food Allergies & Intolerances

Please ask an encore staff member about the ingredients of any of our menu items.

The Doocot is a licensed premise and can also be hired for private functions, weddings and parties for further information please call +44 (0)141 276 5362.

FLOOR PLAN

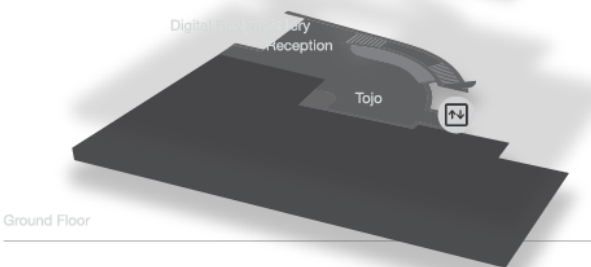
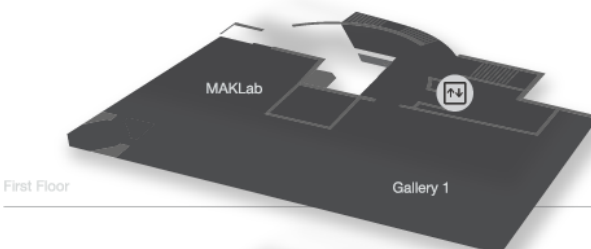
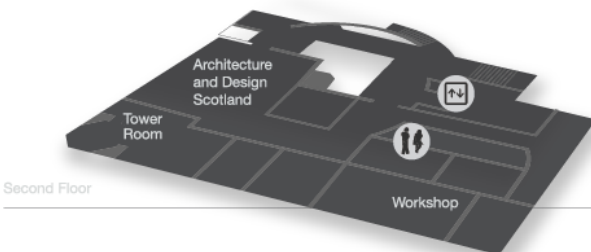
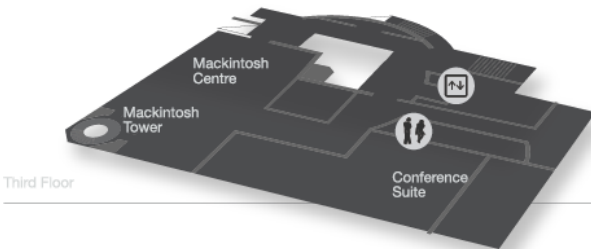
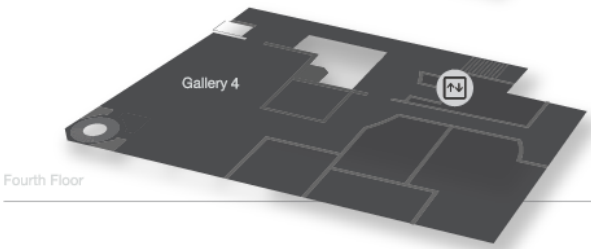
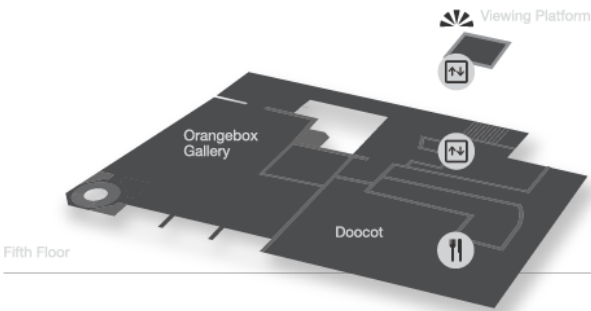

Escalators

There are escalators from the ground level to level 5.
Dimensions: 2 foot wide

Passenger Lift

Ground level to level 6.
Dimensions:
Entrance: 2 foot 11 wide
Inside lift: 4 foot 7 wide
12 people max
900kg max weight

Steps

Ground to Level 1 – 26 steps
Level 1 to level 2 – 29 steps
Level 2 to level 3 – 24 steps
Level 3 to level 4 – 24 steps
Level 4 to level 5 – 24 steps

Floor Plan Image amendments:

Ground level:
Tojo Shop has moved to Wilson Street. The Lighthouse Shop is now open.

Level 1:
MakLAB has moved to Charing Cross

ESSENTIAL INFORMATION

Assistance dogs are welcome on all levels.

The building is fully accessible for buggies – buggy parking area on ground level.

The building is accessible for wheelchair users with the following exceptions:

The Mackintosh Tower on Level 3

The Viewing Platform is not accessible on occasions due to private bookings.

Please phone prior to your visit to avoid disappointment:

+44 (0)141 276 5362.

Rest Areas

Our galleries do not have chairs to allow ample space for visitors. Should you require a chair we are happy to provide one for you.

We have three chairs on level 3 outside the passenger lift.

We have benches in the balcony area (outside) level 3.

Seating area available on level 4, turn right at the top of the escalators.

Tours

Please contact us if you require any assistance with tours. The tours are suitable for all. Our tour guides can work with language interpreters including British Sign Language. We would be more than happy to adapt tours to suit your individual or group needs.

VIRTUAL TOUR

Take a virtual tour before your visit:

<http://www.thelighthouse.co.uk/venue/virtual-tours>

Feedback

We value your feedback here at The Lighthouse, and we really do listen to our visitor's opinions and views. We strive to deliver a very high level of customer service, and would like to hear ways in which you feel we can improve your visitor experience.

Please email us your thoughts: lighthouse@drs.glasgow.gov.uk